

400 BAR CHEK VALVE FORWARD FLOW

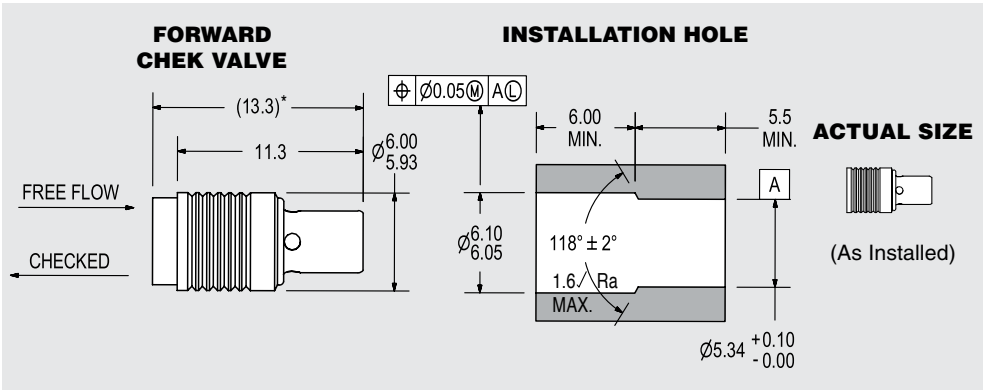

* LOA before installation.
All dimensions in millimeters.

ΔP vs. Flow on Water @80°F (27°C)

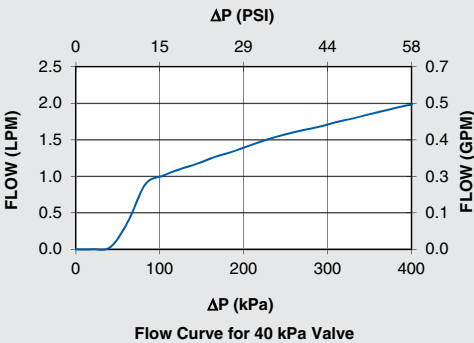

PERFORMANCE

Lohm Rate: 320 Lohms
 Leakage: 20 sccm/min. (max.) @ 172 kPa (25 psid) on air
 1 Drop/min. (max.) on hydraulic fluid
 Maximum Working Pressure:
 400 Bar (5,800 psid) (Checked Direction)
 40 Bar (580 psid) (Flow Direction)

MATERIALS

Body 303 Stainless Steel
 Cage 416 Stainless Steel
 Pin 416 Stainless Steel
 Spring 302 Stainless Steel
 Ball 440C Stainless Steel

INSTALLATION

Tool Part Number CCRT0051078S
 Force 910 Kg F (max.)

[View Installation Procedure](#)

LEE PART NO.	CRACKING PRESSURE
CCHF6010000S	0 kPa (No Spring)
CCHF6010014S	14 ± 5 kPa (2 ± 0.7 psid)
CCHF6010040S	40 ± 30 kPa (6 ± 4.4 psid)