

INSERT CHECK VALVES

400 BAR CHEK VALVE REVERSE FLOW

REVERSE CHEK VALVE

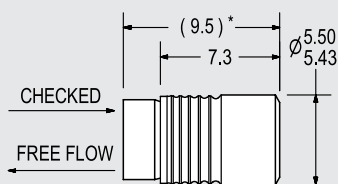

INSTALLATION HOLE

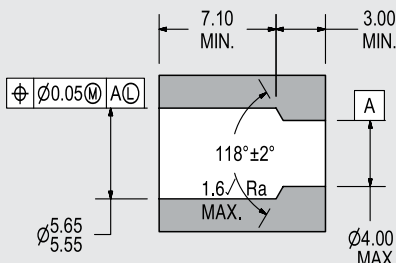

ACTUAL SIZE



(As Installed)

* LOA before installation.
All dimensions in millimeters.

ΔP vs. Flow on Water @80°F (27°C)

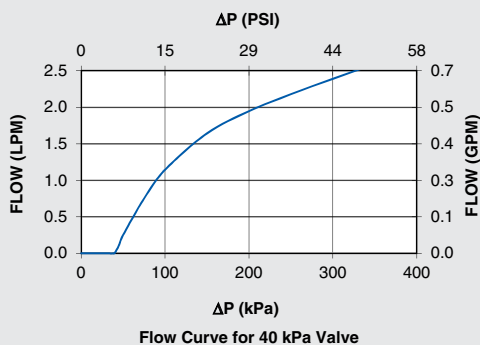

PERFORMANCE

Lohm Rate: 250 Lohms

Leakage: 20 sccm/min. (max.) @ 172 kPa (25 psid) on air
1 Drop/min. (max.) on hydraulic fluid

Maximum Working Pressure:
400 Bar (5,800 psid) (Checked Direction)
40 Bar (580 psid) (Flow Direction)

MATERIALS

Body 303 Stainless Steel
Cage 416 Stainless Steel
Pin 416 Stainless Steel
Spring 302 Stainless Steel
Ball..... 440C Stainless Steel

INSTALLATION

Tool Part Number CCRT0900120S
Force 625 Kg F (max.)

[View Installation Procedure](#)

LEE PART NO.	CRACKING PRESSURE
CCHR5510000S	0 kPa (No Spring)
CCHR5510014S	14 ± 5 kPa (2 ± 0.7 psid)
CCHR5510040S	40 ± 30 kPa (6 ± 4.4 psid)