

INSERT SHUTTLE VALVES

5.5mm SHUTTLE VALVE

SHUTTLE VALVE

INSTALLATION HOLE

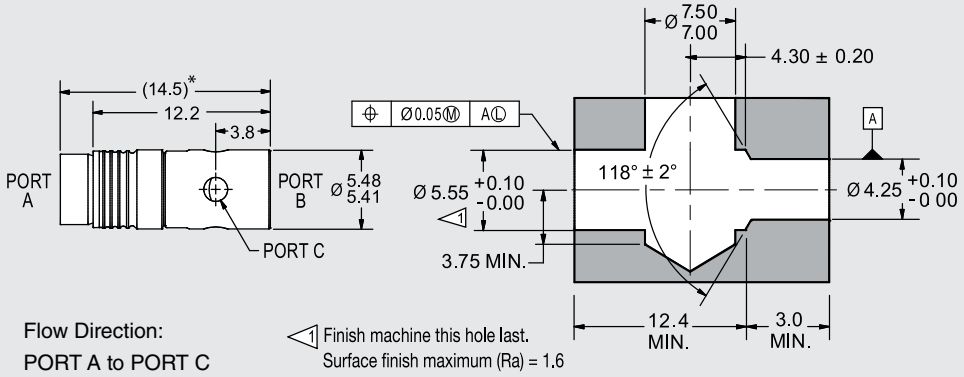

* LOA before installation.
All dimensions in millimeters.

ACTUAL SIZE



(As Installed)

ΔP vs. Flow on Water @80°F (27°C)

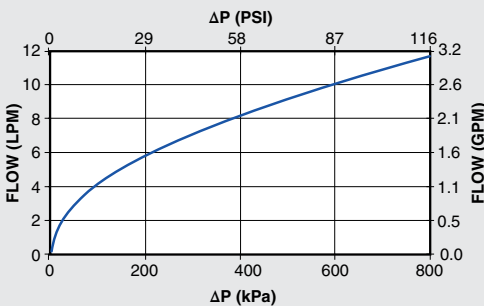

LEE PART NUMBER

CCSV5510000S

PERFORMANCE

Flow Rate: (A to C or B to C) 75 Lohms max. (2 GPM @ 50 psid)

Shuttling

Pressure: 7 kPa (1 psi) maximum

Leakage: A to B or B to A, 1 Drop/min. (max.) after 2 minute wait on hydraulic fluid at 6.9-27.6 MPa (1,000 - 4,000 psid)

Maximum Working Pressure: 28 MPa (4,060 psid)

MATERIALS

Upper Body.....303 Stainless Steel
Lower Body.....303 Stainless Steel
Pin416 Stainless Steel
Ball.....440C Stainless Steel

INSTALLATION

Tool Part Number CCRT0900120S

Force 545 Kg F (min.)
635 Kg F (max.)

[View Installation Procedure](#)